

2006 Cadillac XLR : Engine Electrical > Repair Instructions > Removal, Installation, and Replacement > Generator Replacement (LC3)

[Listen](#)

Generator Replacement (LC3)

GENERATOR REPLACEMENT (LC3)

REMOVAL PROCEDURE

CAUTION

Caution
Refer to Battery Disconnect Caution.

1. Remove the generator drive belt. Refer to [Water Pump and Generator Belt Replacement](#).
2. Disconnect the negative battery cable. Refer to [Battery Negative Cable Disconnection and Connection](#).
3. Drain the cooling system. Refer to [Cooling System Draining and Filling \(Static Fill\) | Cooling System Draining and Filling \(GE 47716\)](#).
4. Remove the front suspension crossmember. Refer to [Front Suspension Crossmember Replacement](#).

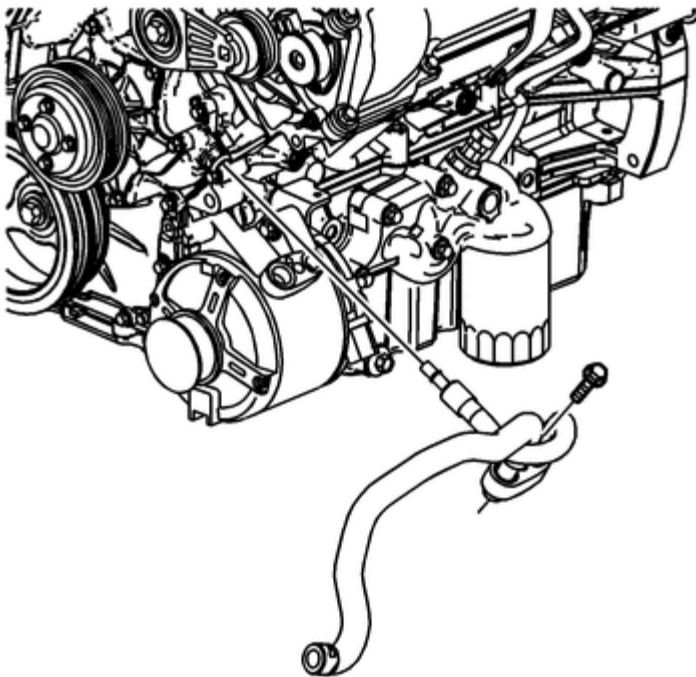

5.

[Click to Enlarge](#)

Remove the bolt from the generator coolant hose assembly on the generator.

6. Disconnect the generator coolant hose assembly from the generator port.

Listen

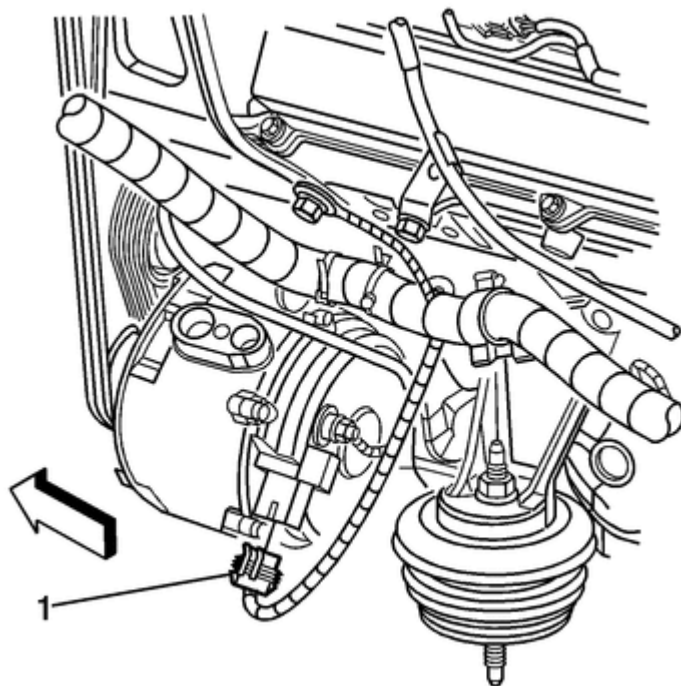

7.

[Click to Enlarge](#)

Disconnect the generator electrical connector (1).

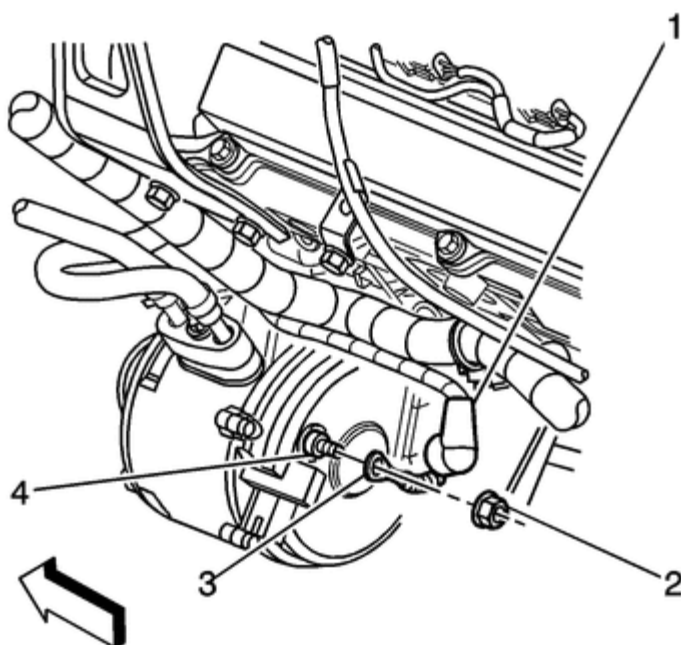

8.

[Click to Enlarge](#)

Remove the starter cable terminal from the generator:

- Slide the boot (1) back along the cable.
- Remove the starter cable nut (2).
- Remove the starter cable terminal (3) from the stud (4).

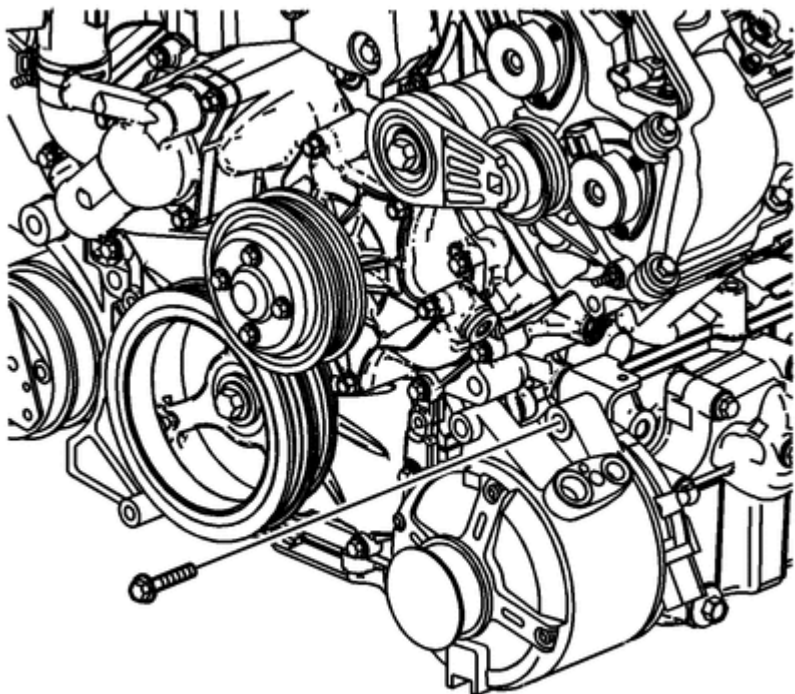

Listen

9.

[Click to Enlarge](#)

Remove the upper generator bolt from the generator.

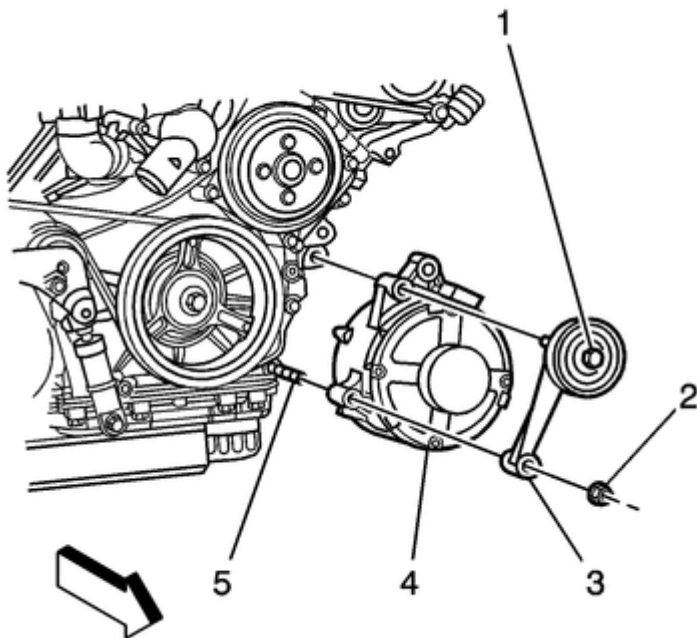

10.

[Click to Enlarge](#)

Remove the idler pulley thru-bolt (1).

11. Remove the idler pulley nut (2).

12. Remove the idler pulley assembly (3).

13. Remove the generator (4).

INSTALLATION PROCEDURE

Listen

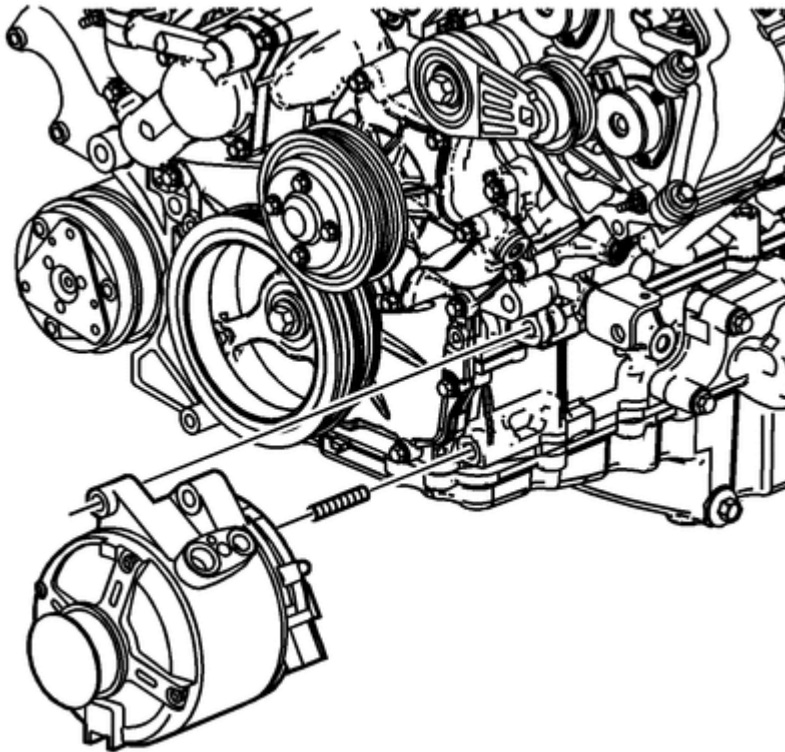

1.

[Click to Enlarge](#)

Install the generator.

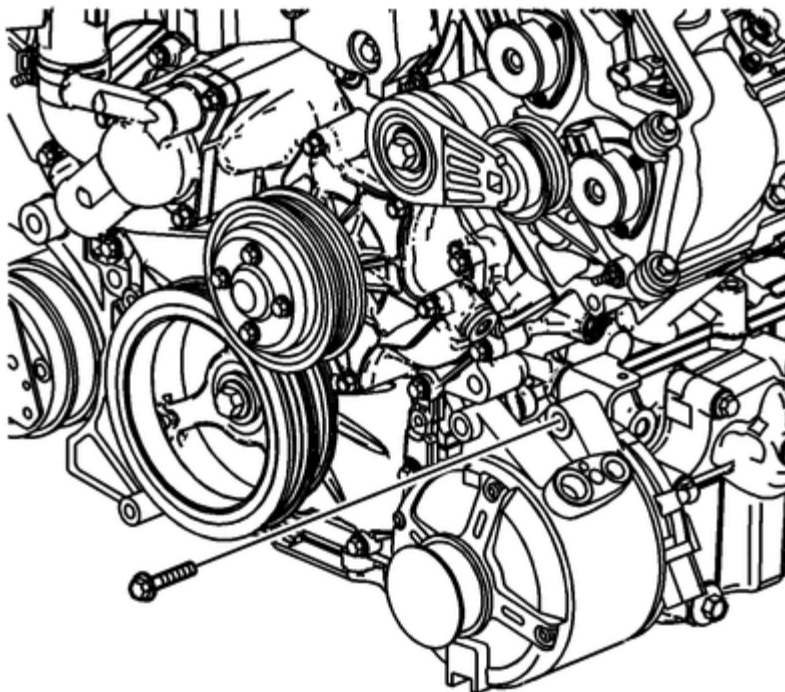

2.

[Click to Enlarge](#)

NOTE

Notice
Refer to Fastener Notice.

Listen

Install the upper generator bolt.

Tighten

Tighten the generator bolts to 50 N·m (37 lb ft).

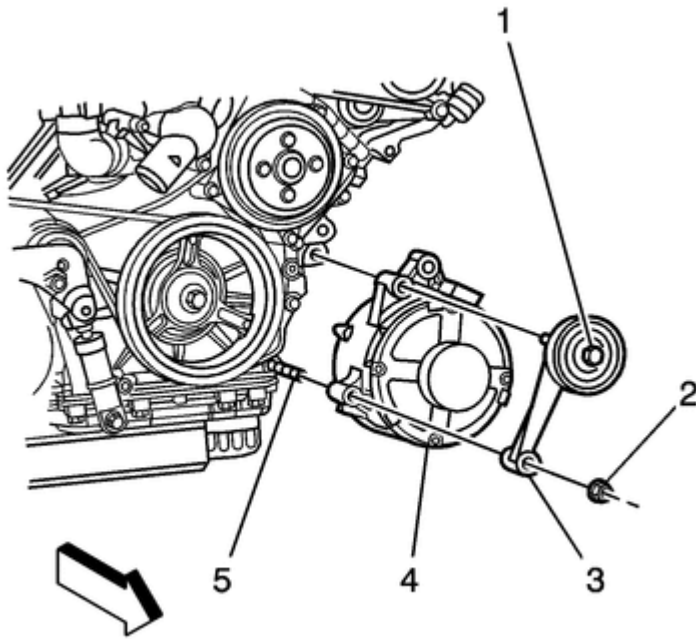

3.

[Click to Enlarge](#)

Install the idler pulley assembly (3) and bolt (1).

4. Install the nut (2).

Tighten the generator fasteners to the following torque values:

Tighten

- Tighten the idler pulley bolt (1) to 50 N·m (37 lb ft).
- Tighten the idler pulley nut (2) to 50 N·m (37 lb ft).

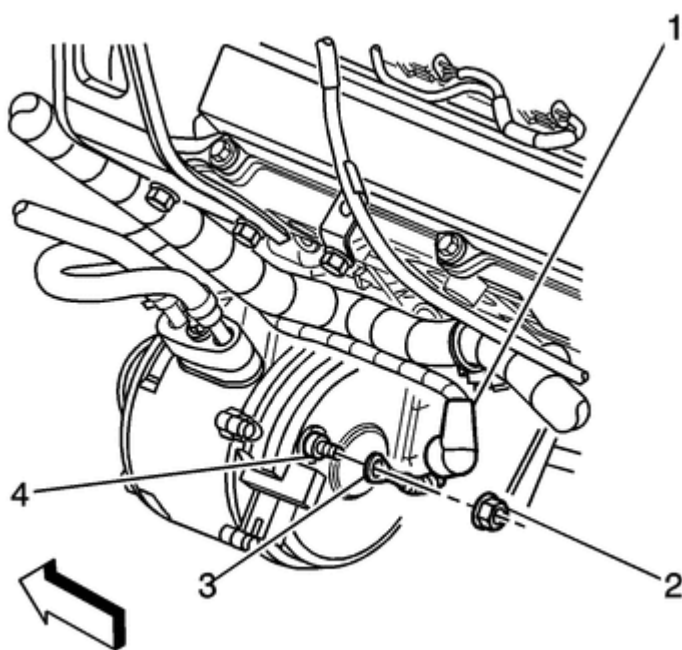
**Listen****5.**[Click to Enlarge](#)

Install the starter cable terminal to the generator:

- Install the starter cable terminal to the stud.
- Install the starter cable nut (2).

Tighten

Tighten the starter cable nut to 20 N·m (15 lb ft).

- Slide the boot (1) over the generator stud (4).

6. Position the generator coolant hose assembly to the generator and secure with the bolt.

Tighten

Tighten the bolt to 27 N·m (20 lb ft).

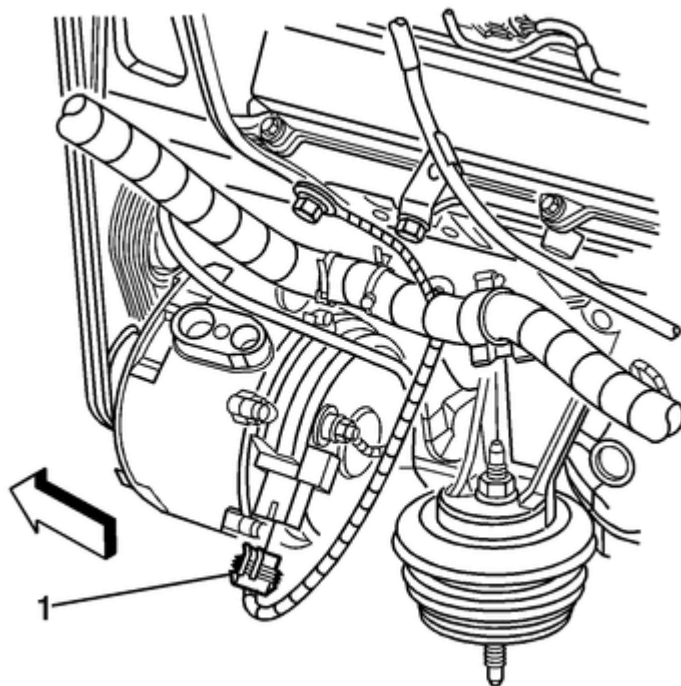

Listen

7.

[Click to Enlarge](#)

Connect the generator electrical connector (1).

8. Install the front suspension crossmember. Refer to [Front Suspension Crossmember Replacement](#).
9. Fill the cooling system. Refer to [Cooling System Draining and Filling \(Static Fill\) | Cooling System Draining and Filling \(GE 47716\)](#).
10. Connect the negative battery cable (2). Refer to [Battery Negative Cable Disconnection and Connection](#).
11. Install the generator drive belt. Refer to [Water Pump and Generator Belt Replacement](#).